

SUPPLEMENT TO THE SPARE PARTS MANUAL

ENGINE 250/300/360 TVC ART.NO. 3.204.00

FIG	TEILNR/PARTNR	DISCRIPTION	QTY
1	546.30.007.600	PISTON CPL. 67,5MM	1
2	546.30.032.000	RECTANGULAR RING 67,5X1	2
3	543.30.074.000	WIRE CIRCLIP SKA 18	2
4	546.30.033.000	PISTON PIN 250/300	1
5	546.37.061.644	CONTROL ROLLER CPL. 250 SGP	2

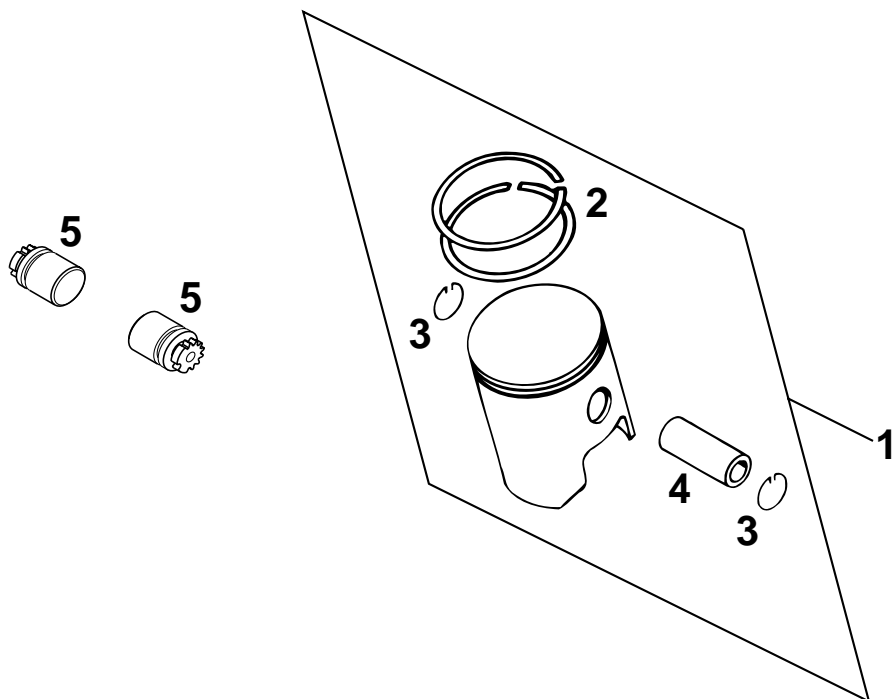

TECHNICAL DATA - ENGINE

Engine	250 EGS '97
Design	Liquid-cooled single-cylinder two-stroke engine with KTM Twin Valve Control exhaust system
Piston displacement	249 ccm
Bore / stroke	67,5 / 69,5 mm
Fuel	SUPER fuel, research octane no 95, mixed with two stroke oil
Oil / gasolin ratio	1:50 - 1.60 when using high grade two stroke oil. When in doubt, please contact your importer or use 1:40 mix ratio to be on the safe side
Crankshaft bearing	1 deep-groove ball bearing / 1 cylinder roller bearing
Connecting rod bearing	needle bearing
Piston pin bearing	needle bearing
Piston	cast
Piston ring <small>(upper edge piston - upper edge cylinder)</small>	two plain compression rings
Dimension "X"	0,2 mm - 0,3 mm
Ignition timing	1,1 mm ± 0,1 mm (13°) BTDC
Spark plug	NGK BR 8 ECM
Electrode gap <small>(height of the control flap)</small>	0,6 mm
Dimension "Z"	46 mm
TVC start open	5400/min
TVC fully open	7550/min
Primary drive	straight cut spur gears, primary ratio 25:72
Clutch	multiple disc clutch in oil bath
Transmission	5 speed, claw actuated
Gear ratio	
1. Gear	15:29
2. Gear	18:26
3. Gear	19:22
4. Gear	21:20
5. Gear	23:18
Gear lubrication	0,8 l engine oil SAE 30
Rear wheel ratio	15:40
Available chain sprockets	13t / 14t / 15t for chain 5/8 x 1/4"
Available final sprockets	38t / 40t / 42t / 45t / 48t / 50t / 52t for chain 5/8 x 1/4"
Coolant	1,3 litres, 40% anti freeze, 60% water, at least -25 °C (-13 °F)
Ignition system	SEM K11 (counterclock)
Generator output	12V 130W
Carburetor	flat-slide carburetor, carburetor setting see table 3
Air-filter	wet foam type air filter insert